



**Safe Store, 198 - 202 Waterloo Road,  
Birmingham, B25 8LD**

**0333 577 9597  
info@vcomfort.co.uk  
www.vcomfort.co.uk**

**Dreamliner 4D**

**MASSAGE CHAIR**

**Model No: A335-2**

**OPERATION INSTRUCTIONS**

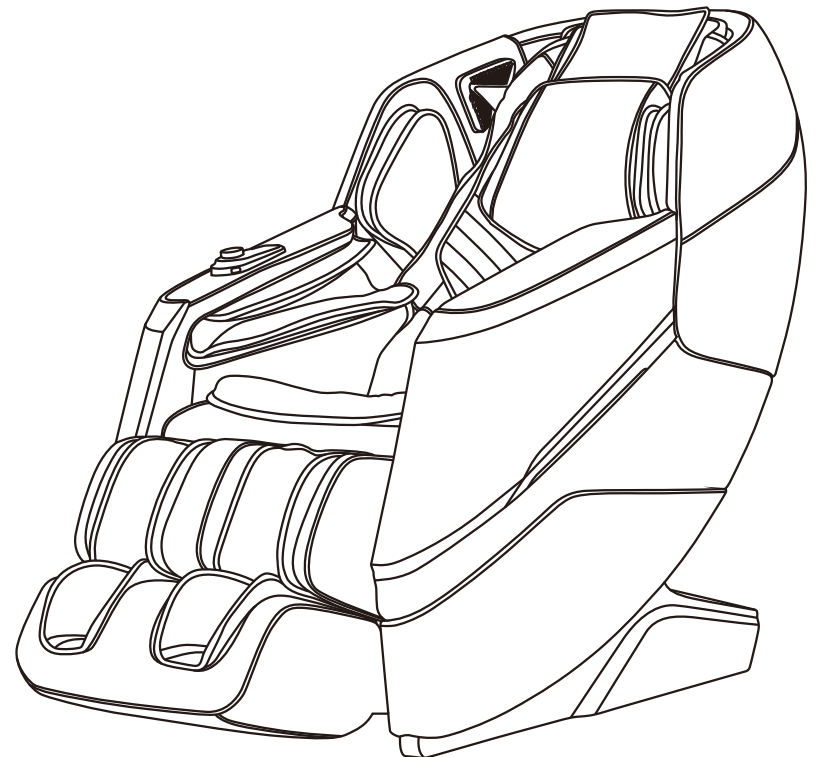

Thanks for purchasing this product. Please read this manual instruction carefully in order to know how to use this product correctly before operation. Please pay more attention to some important safety warning and keep this manual book properly for future use.

Note: Our company reserves the right to change and explain the design of the product. If there is some difference between the product function in market circulation and the description in the manual, it is a normal update of the product, and our company will not inform you otherwise. The specific product function and color shall prevail in kind

## TABLE OF CONTENTS

---

Safety and Maintenance	02-03
Safety Warning	04-06
Name of Components	07
Function	08
Introduction to the Remote Controller	09-10
Method of Usage	11-32
I.Turn on the power supply of this product	11
II.Massage function control operation	11-27
III.Introduction to armrest shortcut keys	28
IV.Voice control mode	28-29
V.Turn off the power and stop massage	30
VI.Operation Instructions for Bluetooth Speaker Play	30
VII.Installation Instructions for Legrest	30-31
VIII.Instructions for removal and use of head cushion and backrest	31
IX.Floor Protection	32
X.Instruction for movement	32
Product Specification	33

## Safety and Maintenance

---

### 1. Important Safety Warnings

- Do not allow children to touch any movable part of this product.
- Use the well-grounded power supply unit suitable for this product.
- Pull out the plug after use or before cleaning to avoid any physical injury or damage to the product.
- Operate this product as instructed in this manual.
- Do not use any parts or accessories which are not recommended.
- Do not use this product outdoors.
- Please read the Operation Instructions carefully before operation.
- Never use this product for any other purpose not listed herein.
- 20 minutes of usage each time is recommended.
- Do not use this product if the leather is broken or damaged.
- Do not use this product if the cover or leather is broken or damaged.
- Do not use this product if the radiator hole is covered or blocked.
- Do not drop anything into this product.
- Never fall asleep while using this product.
- Do not use this product if you are drunk or feel unwell.
- Do not use this product within one hour after a meal.
- Do not use this product with excessive force to avoid any injury.
- Do not carry any fragile, explosive, or combustible material in your pocket, such as a mobile phone and lighter when using the massage chair.

### 2. Operating Environment

- Do not use this product in a very moist environment such as the bathroom.
- Stop using this product immediately when the ambient temperature changes sharply.
- Do not use this product in any heavily-dusty or caustic environment.
- Do not use this product in a small space or a place without good ventilation.
- The normal room temperature ranges from 0 °C to 35 °C.
- Do not use this product in an excessively humid room such as a bathroom. Use it at a relative humidity between 20% and 80%.
- Do not use this product outdoors.
- Avoid direct sunlight.
- Keep this product away from any heat source such as a stove and air outlet of an air conditioner.
- Do not use this product during thunder or lightning weather.
- Do not use this product in dusty places.

### 3. The following populations should not use this product

- Patients with osteoporosis.
- Patients with heart disease or wearing electronic medical devices such as a pacemaker.
- People who have a fever.
- Pregnant women or women on their menstrual period.
- Patients who are injured or have a skin disease.
- When unsupervised, any children are under the age of 14 and those unconscious are not allowed to use this product.
- People who are told by their physicians to have rest or who feel unwell.
- People whose bodies are wet are forbidden to use this product.
- This product has a hot surface. Persons insensitive to heat must pay attention when using this product.

## Safety and Maintenance

---

### 4. Safety Precautions

- Check whether voltage is consistent with the specification of this product.
- Never insert or pull out the plug with a wet hand.
- Do not let water flow into this product to avoid electric shock or cause damage to this product.
- Do not pull the power cord when plugging or unplugging it. Rough handling is forbidden.
- Do not damage the wire or modify the circuit of this product.
- Do not clean live parts of this product with a wet cloth such as a power switch and plug.
- Be away from this product in case of power failure to avoid any injury if power is restored suddenly.
- Stop using this product at once while it works abnormal, and consult your local supplier.
- Stop using this product if you feel unwell, and consult your health care practitioner.
- This product is not intended for use by persons (including children) with reduced physical, sensory or mental capabilities, or lack of experience and knowledge, unless they have been given supervision or instruction concerning the use of this product by the personnel responsible for their safety. Children should be supervised to ensure that they do not play with this product.
- If the power cord is damaged, it must be replaced by the manufacturer, its service agent or similarly qualified staff in order to avoid hazards.

### 5. Product Service and Maintenance

- This product should be maintained by the service center designated by the manufacturer only. No user should disassemble or maintain it without permission.
- Do not forget to turn off the main power switch after usage.
- Do not use this product if the power socket becomes loose.
- If this product will be left unused for a long period of time, it is necessary to roll up the power cord of this product and store this product in a dry and dust-free environment.
- Do not store this product at a high temperature or near open flame. Avoid prolonged exposure to direct sunshine.
- Please clean this product with dry cloth. Never use thinner, benzene or alcohol.
- The mechanical components of this product are specially designed and manufactured, so no special maintenance is needed.
- Do not use a sharp object to stab at this product.
- Do not roll or pull this product on any uneven ground. Instead, it should be lifted before moving.
- Please use this product intermittently. Do not keep it working continuously for a long period of time.

### 6. Solutions to Ordinary Malfunctions

- If the motor sounds during operation of this product, this is the normal operation sound.
- If the controller cannot work normally, check whether the plug and the power socket are connected reliably, and whether the power switch is turned on.
- If the rated working time is over, this product will automatically activate the power-off button; If this product keeps operating for a long period of time, the temperature protector will stop this product automatically. The product can be used again after half an hour.

### 7. Storage Conditions

- Storage room temperature: -5 °C to 35 °C.
- Relative humidity (RH) between 20% and 80%; free of corrosive gases, and a well-ventilated room.

## Safety Warning

### ⚠ Warning

When the legrest of the massage chair is lifted, nobody should apply pressure on the legrest to prevent the massage chair from falling forward which will damage this product or result in personal injuries.

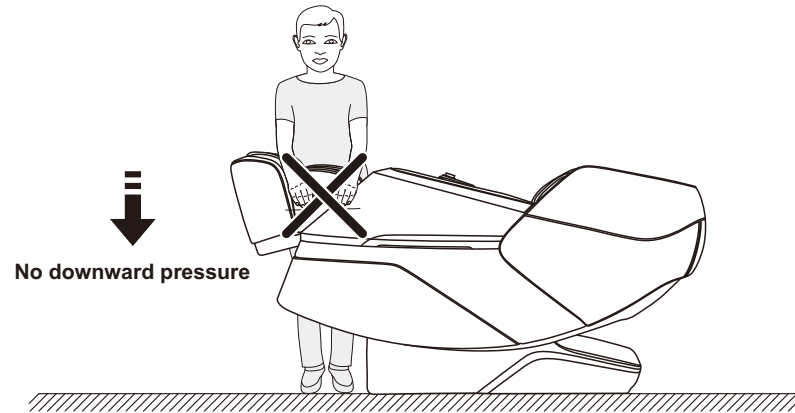

### ⚠ Warning

Before sitting on the massage chair, make sure that the massage chair manipulator does not stay in the seat cushion position to avoid discomfort to the buttocks during the body pressing down and any damage to the massage chair manipulator.

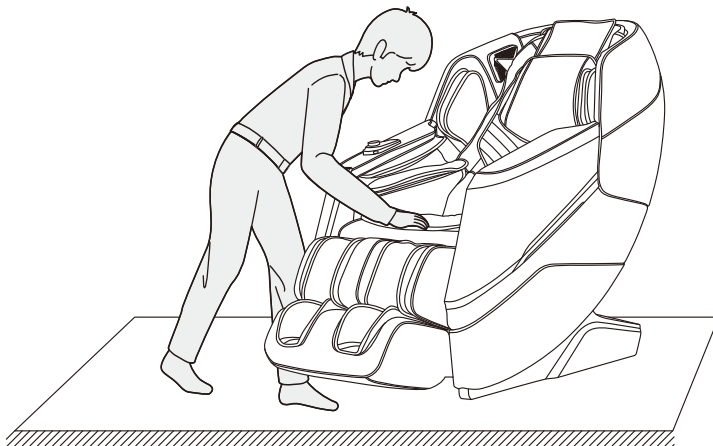

04

## Safety Warning

### ⚠ Warning

Do not remove or pull out the remote controller cable or the power cord in the standby or power-on state to avoid any damage to this product or accidental electric shock of a body part. You are advised to unplug the remote controller cable and the power cord and put them away after you use the massage chair.

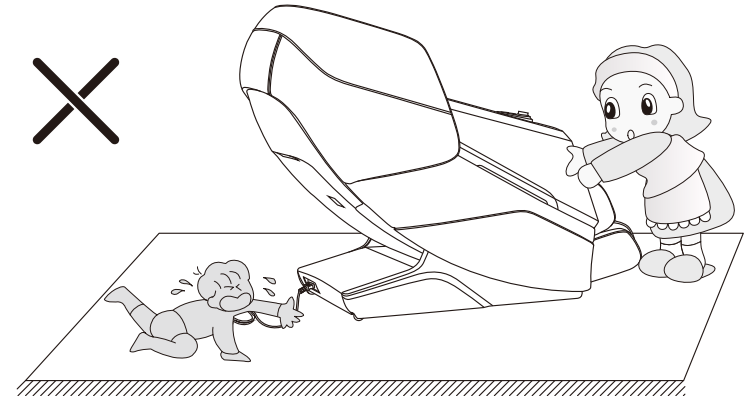

### ⚠ Warning

When the zero-gravity lying function is enabled, be sure to check whether there is any child or pet staying or playing under the bottom of the legrest and backrest, in order to avoid any damage to this product or physical injury.

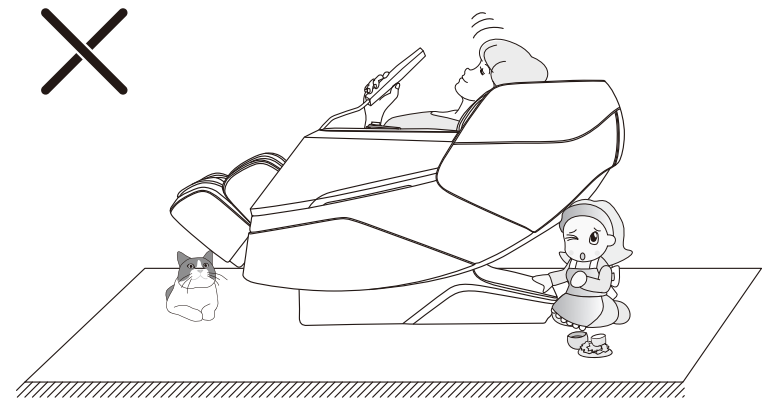

05

## Safety Warning

### Warning

Before using the massage chair, remove any hard objects in your pocket(s) or any jewelry carried with you (e.g. key, watch, other similar portable hard objects) to avoid any damage to this product or physical injury during massage.

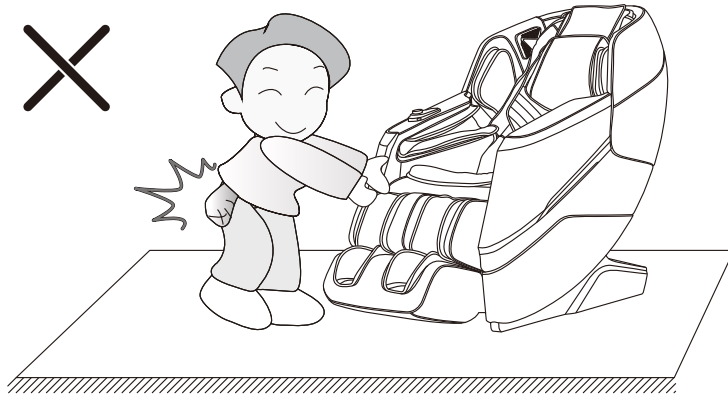

### Warning

Do not unplug the power cord, or directly turn off the power switch on the back of the massage chair during massage, in order to avoid any damage to this product or physical injury.

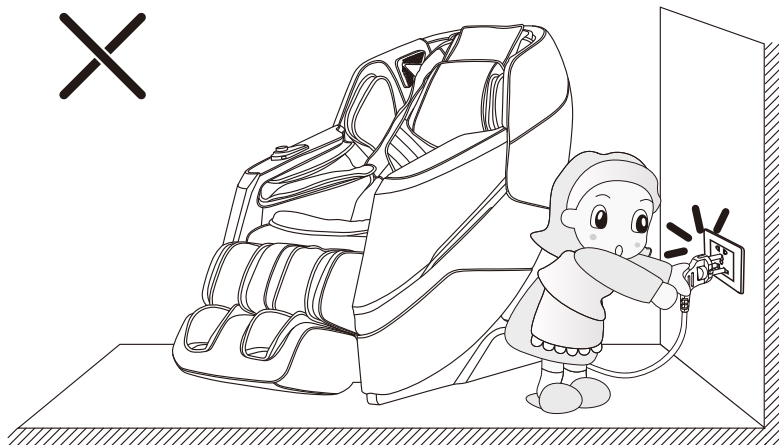

## Name of Components

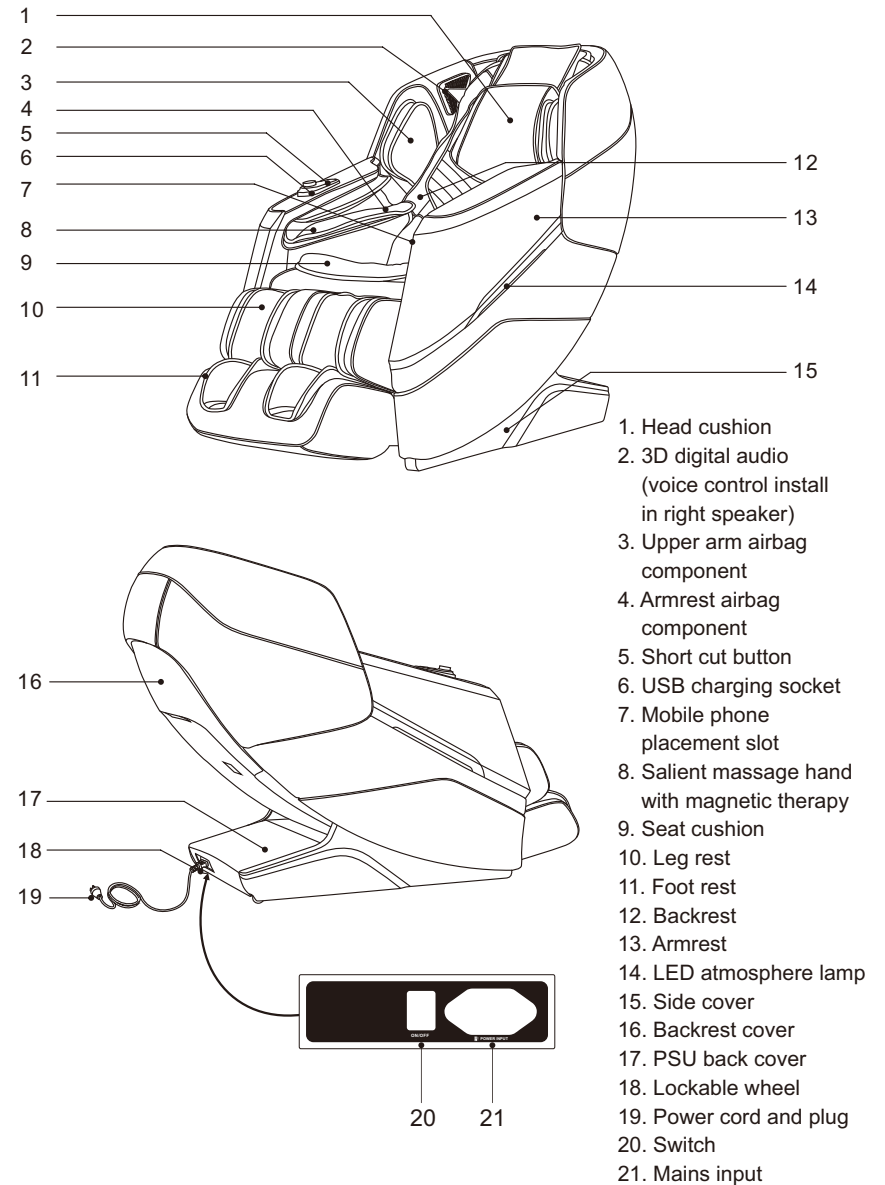

## Function

- This product is designed with a group of intelligent and silent massage hand that can move up and down and four-wheel drive.
- There are five kinds of simulated massage modes such as shiatsu, kneading, tapping, kneading and tapping.
- It can automatically detect the shoulder position.
- With 18 special automatic massage functions: Fast massage, Comfort massage, Relax massage, Stretch massage, Neck&shoulder massage, Back&waist massage, Full body massage, Vertebral massage, Fatigue recovery, Relieving rigidity, Hip shaping, Sleep massage, Sport recovery, Regimen, President massage, Vitality stimulation, Pain relief, White collar.
- There are five intelligent memory functions (M1, M2, M3, M4, M5): Remarks on saved massage functions and techniques are available (e.g. father, mother, daughter, son, or none).
- The upper half manually selects the massage function; there are five kinds of massage position selections such as partial, fixed point, full, upper back and lower back; shoulder lifting, kneading, tapping, shiatsu and kneading and tapping five massage techniques; the massage technique has five speeds that can be adjusted; when massaged in tapping and shiatsu mode, the robot massage ball have three widths to adjust.
- Air massage function: upper arm air pressure massage function (built in 4 airbags), arm air pressure massage function (built in 8 airbags), palm air pressure massage function (built in 8 airbags), leg air pressure massage function (built in 16 airbags), and three levels for air pressure intensity adjustment.
- The back and calf heating function use carbon fiber as an infrared heating source, and three levels for heating temperature adjustment.
- Intelligent voice control and identification function.
- In the air bags for left and right palms, there are salient massage with magnetic therapy function.
- As the backrest reclines down, this product is built to space save by making the chair slides forward.
- The backrest rail adopts "SL" rail technology, which fits perfectly with the curve of the back of human body and can enjoy close-fitting massage from head to thigh.
- Music playback system: built in 3D digital speaker on left and right arms. The Bluetooth function of the smart device can be used to play music on a wireless connection.
- Equipped with independent up/down adjustment function of the leg rest, linkage up/down adjustment function, and zero-gravity function.
- There have ON/OFF button, pause button, auto mode button, voice control button, zero gravity button etc. at the right arm rest
- The foot roller massage function is available for the feet bottoms. Three sets of rollers roll to massage the roots of toes; rolling and scraping massage is available for foot arch.
- There have USB charging function in mobile phone slot at the front end of right arm rest.
- The left and right armrests are equipped with LED atmosphere lamps.
- Equipped with TFT color screen manual remote controller.
- Automatic shutdown reset function, massage head automatic reset function.

## Introduction to the Remote Controller

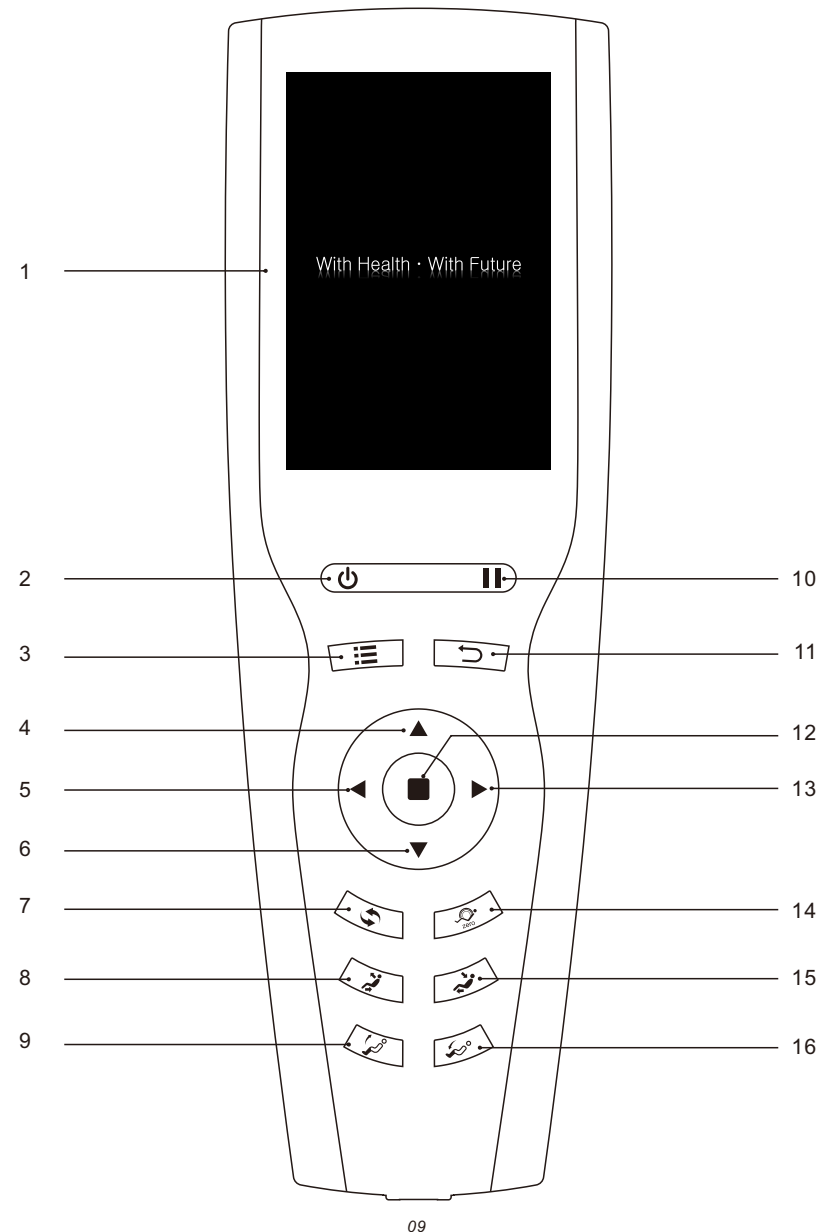

## Introduction to the Remote Controller

1. Display:
  - TFT color LCD showing the massage functions in the running state.
2. Switch:
  - Turn on or off the massage.
3. Menu key:
  - Enter the main menu selection interface. For more information about the functions, refer to Page 15 of the Operation Instructions.
4. Up key:
  - Up navigation key: select an object upward in the menu, or adjust the massage position upward.
5. Left key:
  - Left navigation key: return to the previous menu, or select an object leftwards.
6. Down key:
  - Down navigation key: select an object downward in the menu, or adjust the massage position downward.
7. AUTO key:
  - Enter the automatic function mode selection interface. For more information about the functions, refer to Page 13 of the Operation Instructions.
8. Linkage sitting key:
  - According to the required massage angle, simultaneously adjust linkage sitting function of the backrest and leg rest for the most comfortable linkage sitting massage posture.
9. Leg rest Up key:
  - Adjust the leg rest upward according to your own massage needs for the most comfortable massage posture.
10. Pause key:
  - Pause all the massage functions currently in service. Press this button again to continue to run all the massage functions before such pause.
11. Return key:
  - Return to the function information interface under the current running state, or return to the previous interface.
12. OK:
  - Confirm the selected massage function for massage.
13. Right key:
  - Right navigation key: enter the sub-menu, or select an object rightwards.
14. Zero-gravity key:
  - Adjust the angle of the massage chair for zero gravity. There are a total of four modes to choose from (i.e. 1st pressing is Level 1; 2nd pressing is Level 2; 3rd pressing is Level 3; and 4th pressing makes the massage chair restore to the original state).
15. Linkage down key:
  - According to the required massage angle, simultaneously adjust linkage down function of the backrest and leg rest for the most comfortable linkage down massage posture.
16. Leg rest down key:
  - Adjust the leg rest downward according to your own massage needs for the most comfortable massage posture.

## Method of Usage

### I. Turn on the power supply of this product

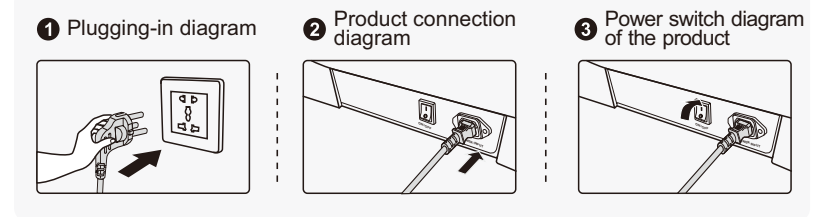

### II. Massage function control operation

#### 1. Standby

- After the massage chair is powered on and turned off, the remote controller is blank in the standby state (i.e. the LED lamp is off) and cannot perform any operation (except the key switch).



#### 2. Start to massage (power switch)

- Press "Power" button to start massage, enter the boot screen, backrest maintains the default position.
- After automatically lying down to the default position, massage chair will automatically detect the shoulder position and body (note: fast mode only detect shoulder position, other modes detect whole body and shoulder position), waiting the detection finish. Or you can press "confirm" button, the massage chair will directly start to massage in default without shoulder position and body sensing.

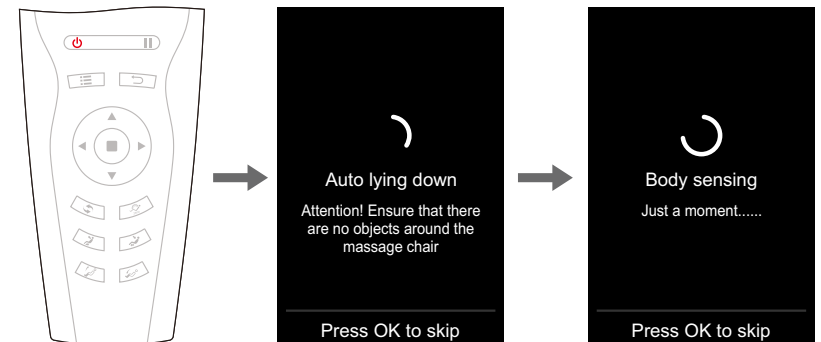

## Method of Usage

· After testing the shoulder position, sounded with "di-di-di" notification tone, you can adjust the shoulder position by press up or down button according to users' height in small scale. There have 11 levels for shoulder adjustment. If without adjustment in 10 seconds, then into the massage function automatically. Or directly press "confirm" button enter the massage immediately. If massage chair does not test shoulder position, the massage will start with default position.

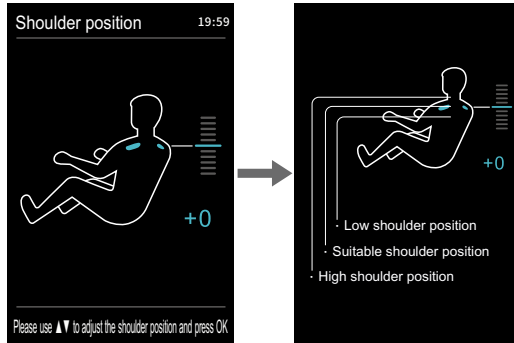

Button	Description
	Move the massage balls upward to a suitable shoulder position
	Move the massage balls downward to a suitable shoulder position

· If you need to adjust the shoulder position after the massage program is started, you can directly select "Shoulder Position Adjustment" to enter the shoulder position adjustment interface; you can press "Up Key" or "Down Key" to adjust the shoulder position height; you can press "Left Button" to return to the previous menu, or wait for 10 seconds to automatically return to the information interface.

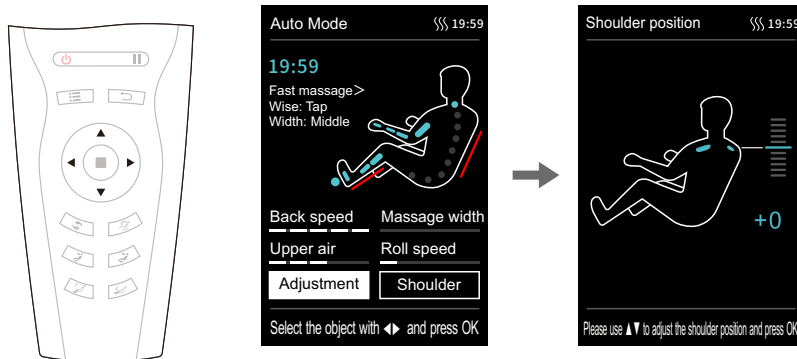

## Method of Usage

### 3. Pause button

· While the massage function is in service, press "Pause" button to temporarily stop all the massage functions; press "Pause" button again to continue the massage function before pause. If the pause time exceeds 20 minutes, all the massage functions will be automatically turned off.

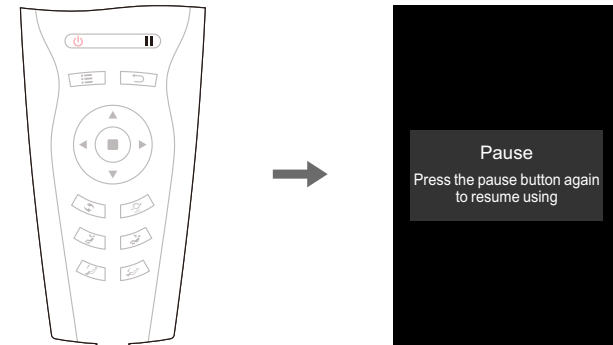

### 4. Menu button

· Press "Menu Button" to enter the massage function selection interface of the main menu, including automatic, manual, and other functions, intelligent storage, angle adjustment, settings and other function interfaces.  
 · Press "up" or "down" button choose the menu, press "confirm" button to confirm enter the choosing menu interface. Press "return" button to return the function selection information interface.

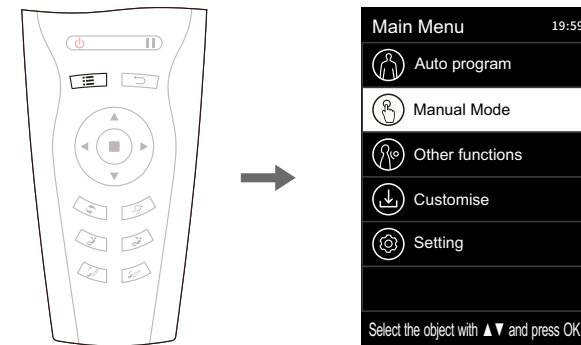



## Method of Usage

### 1) Automatic function (main menu - automatic function)

- Press "Menu Button" to enter the main menu interface. Press "Up Key" or "Down Key" to select the automatic functions. Press "OK" (or press "AUTO Key" directly in the information interface) to enter the selection of automatic functions
- 18 special automatic massage functions are available: Fast massage, Comfort massage, Relax massage, Stretch massage, Neck&shoulder massage, Back&waist massage, Full body massage, Vertebral massage, Fatigue recovery, Relieving rigidity, Hip shaping, Sleep massage, Sport recovery, Regimen, President massage, Vitality stimulation, Pain relief, White collar.
- Enter the automatic function interface. Press "Up Key" or "Down Key" to select any automatic function massage program. It will automatically return to the information interface, which will be displayed as the automatic function information interface.

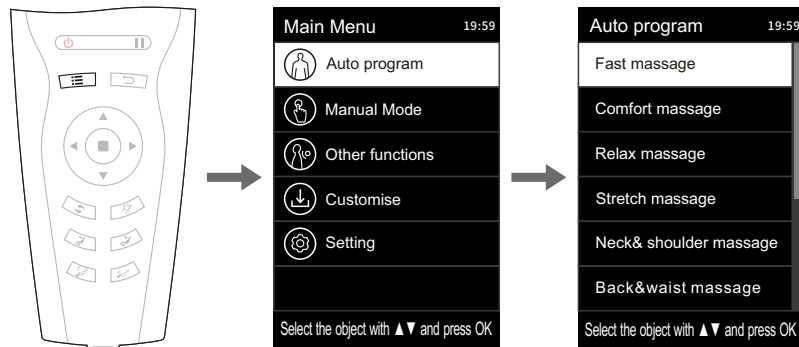

Function	Description
Fast massage	Experience all the massage effects quickly.
Comfortable massage	The most comfortable massage experience.
Relax massage	Gentle and comfortable deep massage to relieve your body fatigue and relax the body.
Stretch massage	Stretch your legs and waist through the leg rest and the backrest to effectively remove fatigue, relieve joint pain and restore vitality.
Neck & shoulder massage	With the unique massage technique for the neck and shoulder, the effective massage for the cervical spine and scapula can be performed to relieve the neck and shoulder pain and reduce fatigue on the neck and shoulder.
Back & waist massage	Focus on the back and waist massage to relieve the pain on the back and waist.

## Method of Usage

Full body massage	Deep massage to rejuvenate your body.
Vertebral massage	Focus on spine massage and fully relieve the fatigue and pain from your body.
Fatigue recovery	Deep massage on the acupressure points can effectively relieve ache.
Relieving rigidity	Improve overall blood circulation of body to enhance vitality and immunity.
Hip shaping	Effective massage for the buttocks and thighs, plays a role in shaping the body, reducing the accumulation of excess body fat.
Sleep massage	In 30 minutes, massage in 3 stages with different modes, different intensities and degrees to induce sleep.
Sport recovery	Quickly recover from fatigue after exercise.
Regimen	Increase physical exercise by massage, improve the body functions of Office Sedentary.
President massage	Relieve fatigue and relax muscle, improve micro-circulation of back & limbs and quickly relieve stress.
Vitality stimulation	After a night's rest, the body is rested. Through the overall massage of whole body muscles, various functions of the body are quickly awakened and a new day full of vitality is started. Sports care: quickly recover from fatigue after exercise
Pain relief	Effectively promote the body meridians, eliminate fatigue, promote blood circulation, improve body immunity, and relieve muscle fatigue and pain.
White collar	It is suitable for the elderly, the massage strength is lighter overall, the movements are gentle, and it is also suitable for people who are not stressed.

Note: The automatic functions in service already selected will be displayed in the massage function status bar.

## Method of Usage

### 2) Manual function (main menu - manual function)

- Press "Menu Button" to enter the main menu interface. Press "Up Key" or "Down Key" to select the manual function, and press "OK" to enter the manual function interface.
- 5 manual massage techniques/functions: OFF, kneading, Tapping, simultaneous kneading and tapping, Shiatsu, knocking, etc.
- After entering the manual function interface, press "Up Key" or "Down Key" to select the required manual massage technique. Press "OK" to confirm. Press "Left Button" to return to the previous interface. After returning to the information interface, you will find that you have entered the information interface of the manual function.

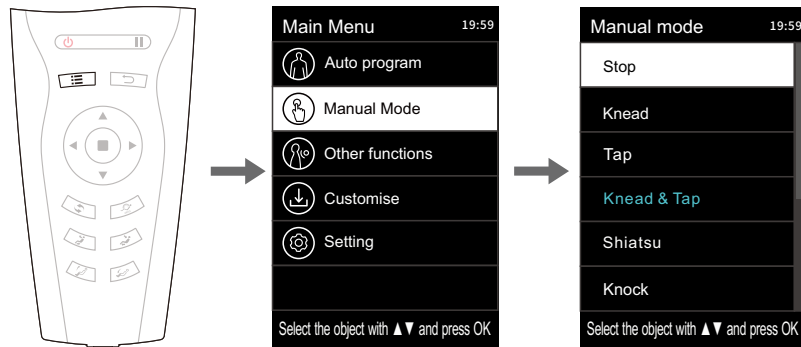

Function	Description	
Kneading	Speed	<ul style="list-style-type: none"> <li>· 5 speed levels adjustable</li> <li>· 3 width levels adjustable</li> </ul>
Tapping	Speed, width	
Simultaneous kneading and tapping	Speed	
Shiatsu	Speed, width	
Knocking	Speed, width	

## Method of Usage

### 3) Other functions (main menu key - other functions)

- Press "Menu Button" to enter the main menu interface. Press "Up Key" or "Down Key" to select other function icons. Press "OK" to enter another function interfaces.
- Other functions include: airbag massage for the upper body, airbag massage for the lower body, back heating, legs heat and other massage functions.
- After entering another function interface, press "Up Key" or "Down Key" to select the massage function. After selecting any one of the functions, use "Right Button" to enable or disable the function. Then press "OK" to confirm. Press "Left Button" to return to the previous menu interface.

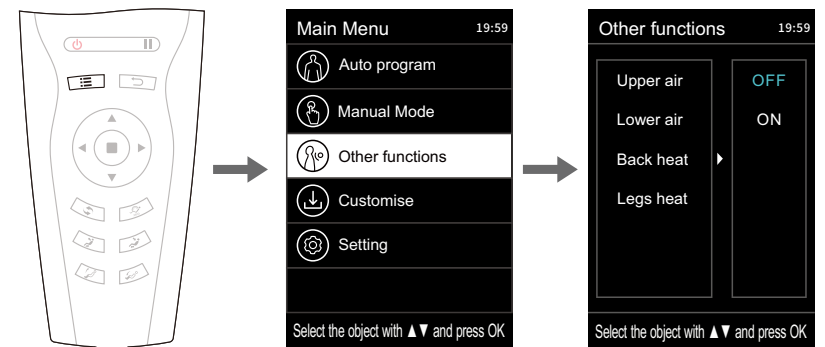

#### 01) Other functions - airbag massage for the upper body

- Airbag massage for the upper body: including airbag massage for the upper arms pressure, airbag massage for the arms and other airbag massage functions.
- Enter another function interface. Press "Up Key" or "Down Key" to select the airbag massage function for the upper body. Use "Right Button" to enable or disable the airbag massage function for the upper body. Then press "OK" to confirm. Press "Left Button" to return to the previous menu interface.

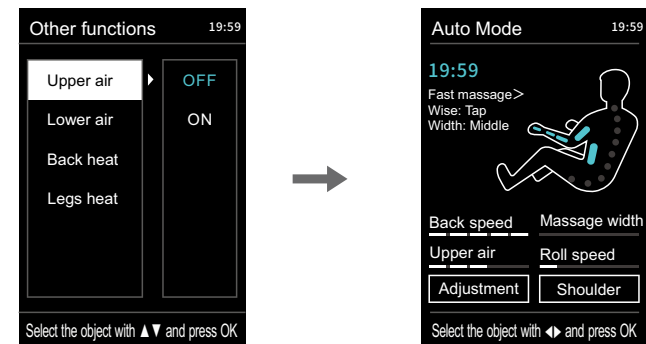

## Method of Usage

### 02) Other functions - airbag massage for the lower body

- Airbag massage for the lower body: including airbag massage functions for the legs, feet, etc.
- Enter another function interface. Press "Up Key" or "Down Key" to select the airbag massage function for the lower body. Use "Right Button" to enable or disable the airbag massage function for the lower body. Then press "OK" to confirm. Press "Left Button" to return to the previous menu interface.

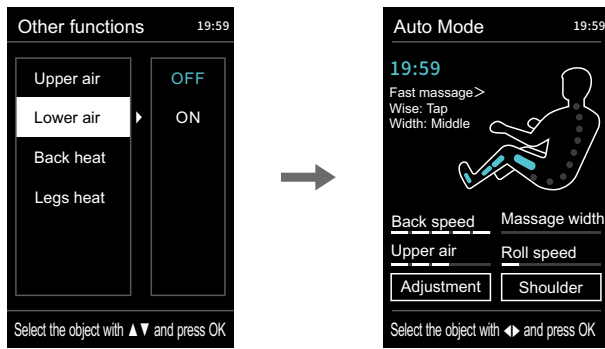

### 03) Other functions - back heating

- Back heating: enable or disable the back heating function; the back will become warmer after such heating for 3min.
- Enter another function interface. Press "Up Key" or "Down Key" to select the back heating function. Use "Right Button" to enable or disable such function. Then press "OK" to confirm. Press "Left Button" to return to the previous menu interface.

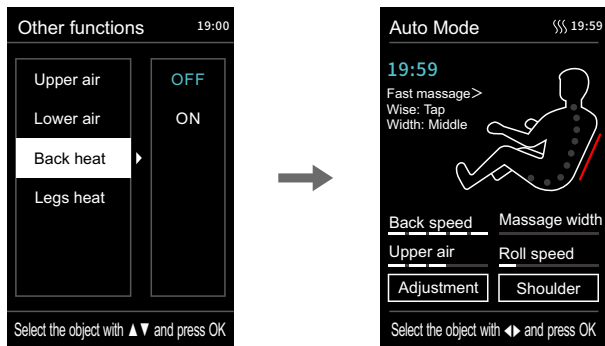

## Method of Usage

### 04) Other functions - leg heating

- Leg heating: enable or disable the leg heating function; the leg will become warmer after such heating for 3min.
- Enter another function interface. Press "Up Key" or "Down Key" to select the leg heating function. Use "Right Button" to enable or disable such function. Then press "OK" to confirm. Press "Left Button" to return to the previous menu interface.

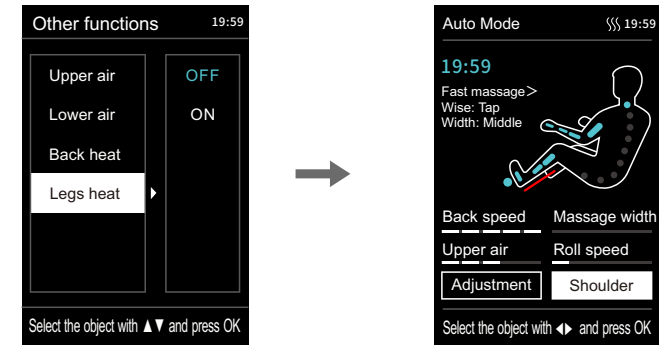

### 4) Intelligent storage (main menu - intelligent storage)

- Press the "Menu Button" to enter the menu interface. Press "Up Key" or "Down Key" to select the intelligent storage icon. Press "OK" to enter the intelligent storage interface, including: intelligent storage call, intelligent storage saving, cancellation and other storage functions.
- Intelligent storage call includes: M1, M2, M3, M4, and M5.
- Intelligent storage saving include: M1, M2, M3, M4, and M5.
- Call: Call the stored massage mode, massage technique, airbag mode and intensity under the current running status, the positions and angles of the legrest and the backrest, and other massage functions.
- Storage: Store the massage mode, massage technique, airbag mode and intensity under the current running status, the positions and angles of the legrest and the backrest, and other massage functions.
- Cancellation is the exit option.  
Note: When saving the massage method, you can comment on the saved massage function and method (e.g. father, mother, son, daughter, or none).

## Method of Usage

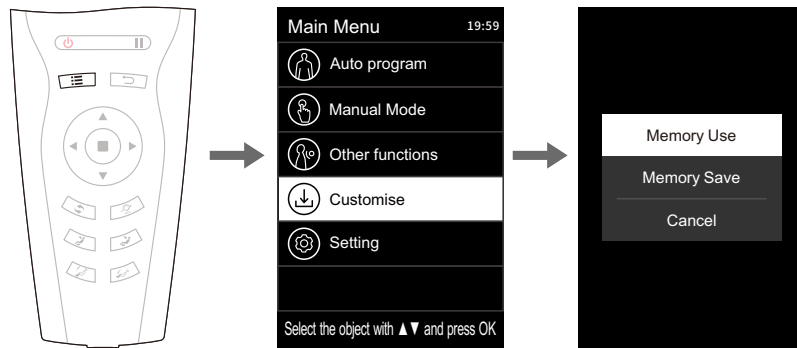

### 01) Intelligent storage - save or cancel

- After entering the intelligent storage (saving) interface, press "Up Key" or "Down Key" to select the message function to be stored. Press "OK" to save or cancel.
- Enter the intelligent storage (saving) interface. Press "Up Key" or "Down Key" to select any one of the M1-M5 saving procedures. Select "OK" to confirm, and comment on the saved message function; press "Left Button" to return to the previous menu interface.

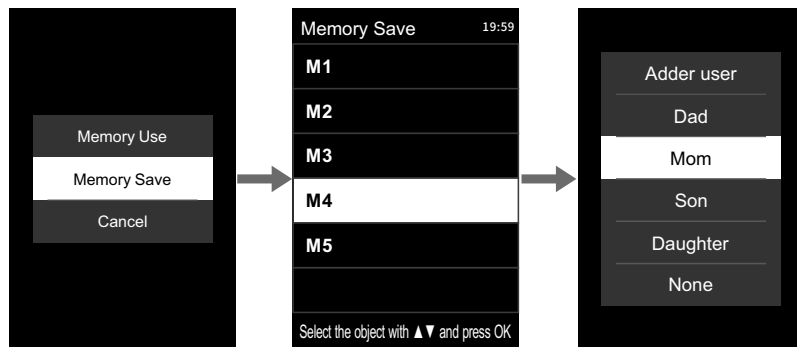

Note: Note: You can comment on the saved message functions and techniques (e.g. father, mother, daughter, son, or none).

### 02) Intelligent storage - call or cancel

- After entering the intelligent storage (call) interface, press "Up Key" or "Down Key" to select the message function to be called. Press "OK" to enter the call or cancellation interface.
- Enter the intelligent storage (call) interface. Press "Up Key" or "Down Key" to select any one of the M1-M5 call procedures required to call the saved message program; press "Left Button" to return to the previous menu interface.

## Method of Usage

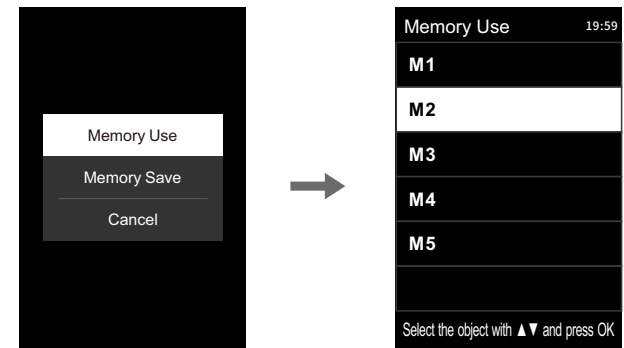

### 6) Settings (Main Menu-Settings)

- Press "Menu Button" to enter the main menu interface. Press "Up Key" or "Down Key" to select the settings icon. Press "OK" to enter the settings interface.
- Settings include: language settings, Bluetooth settings, intelligent voice control, Equipment ID and other settings functions.
- After entering the settings interface, press the "Up Key" or "Down Key" to select the desired settings function. Select any one of the settings functions, and then press "Right Button" to set the selected settings function. Press the "OK" to confirm; press "Left Button" to return to the previous menu interface.

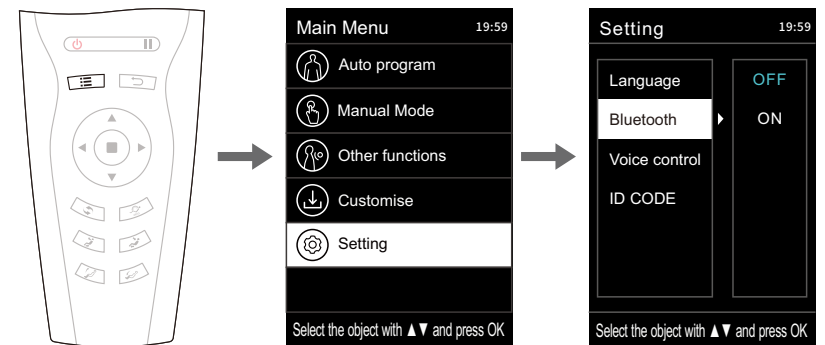

## Method of Usage

### 01)Settings - language settings

- Voice settings: including Chinese and English (the function has memory, that is, after such selection, power-off and restart, it will be the last selected state).
- Enter the settings interface. Press "Up Key" or "Down Key" to select the language settings. Press "Right Button" to enter the language settings. Press "OK" to select the required Simplified Chinese or English; press "Left Button" to return to the previous menu interface.

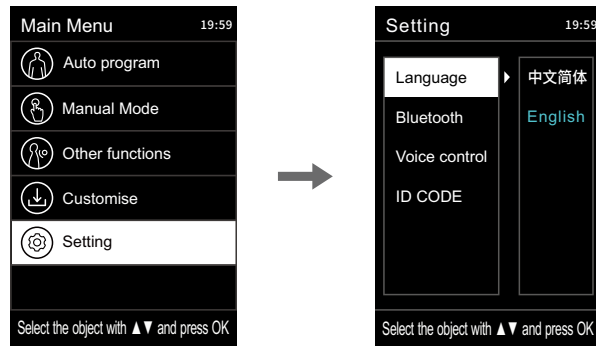

### 02)Settings - Bluetooth settings

- Bluetooth settings (OFF by default): After the Bluetooth function of the massage chair is enabled, the Bluetooth-enabled audio source device (e.g. mobile phone, MID tablet) can be connected with the Bluetooth module of the massage chair, and the music played by the audio source device can be wirelessly transmitted to the audio system of the massage chair via Bluetooth for music playback.
- Enter the settings interface. Press "Up Key" or "Down Key" to select the Bluetooth settings. Press "Right Button" to enter the Bluetooth ON/OFF interface. Press "OK" to select the required ON or OFF; press "Left Button" to return to the previous menu interface.

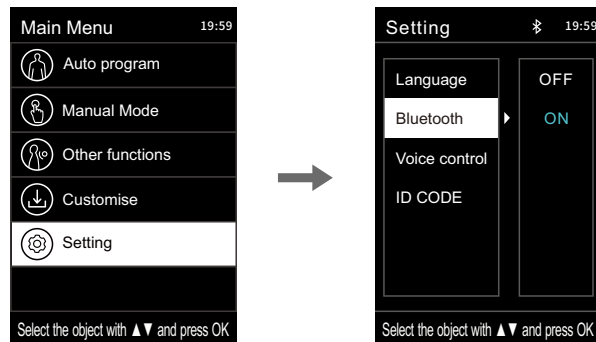

## Method of Usage

### 03)Intelligent Voice Control

- Intelligent voice control: enable or disable the intelligent voice control function (the function has a memory, that is, after such selection, power-off and restart, it will be the last selected state); Note: When the intelligent voice control is disabled, voice wakeup cannot be performed.
- Enter the settings interface. Press "Up Key" or "Down Key" to select the intelligent voice control function. Press "Right Button" to enter the intelligent voice control function settings. Press "OK" to select the required ON or OFF; press "Left Button" to return to the previous menu interface.

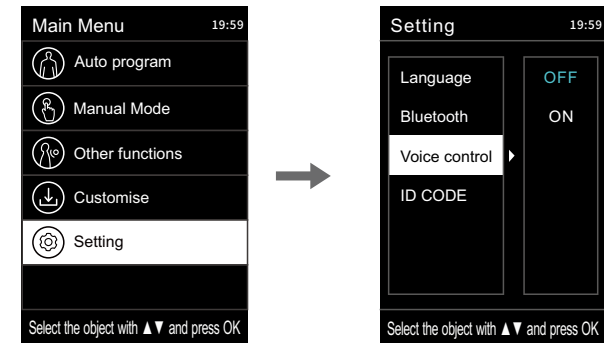

### 04)Equipment ID

- Equipment ID: Display the current device ID number.
- Enter the settings interface. Press "Up Key" or "Down Key" to select the equipment ID and check the equipment number of the current device.

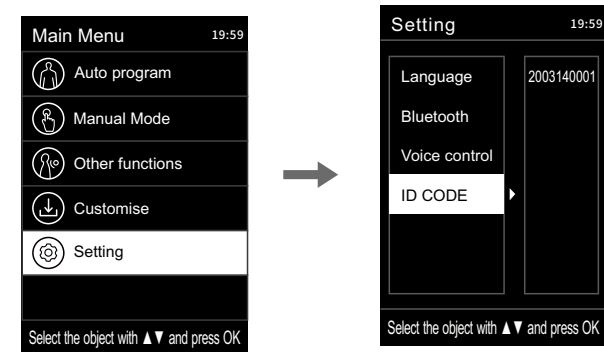

## Method of Usage

### 7) Massage adjustment

- In the state of the information interface, press "Left Button" or "Right Button" to select the massage adjustment button, and press "OK" to enter the massage adjustment interface.
- Massage adjustment includes: 6 massage adjustment functions can be selected, including back massage speed, back massage range, massage width, airbag intensity, roller speed, and massage time.
- After entering the massage adjustment interface, press "Up Key" or "Down Key" to select the desired massage adjustment function. After selecting any one of the desired massage adjustment functions, use "Right Button" to enter the massage level selection interface. Then press "OK" to confirm the selected level. Press "Left Button" to return to the previous menu interface.

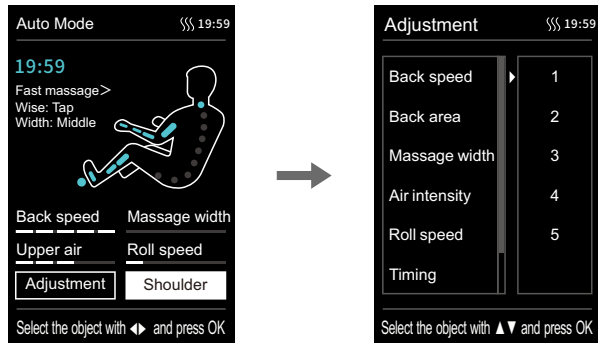

Function	Description
Back speed	5 speed levels adjustable
Back area	There are 5 modes for your choice: fixed point, local area, full back, upper back, and lower back
Massage width	3 width levels adjustable
Airbag intensity	5 intensity levels adjustable
Roller speed	Choose from 4 modes including OFF and Level 1-3
Timing	Choose from 4 modes: +10min, +5min, -5min, -10min

#### Note:

- According to the remaining massage time, when the displayed time is not enough for the addition and subtraction of a certain time, the operation will not be displayed (the upper limit of the time display is 40 minutes). For example: If the display time of the remote controller is 39 minutes, the massage time adjustment range will be: -5min, -10min (+10min or +5min cannot be displayed).

## Method of Usage

- The adjustment of airbag intensity can only be used when the airbag function or the automatic function is enabled (for more information about how to enable the airbag function, refer to Page 18 of the Operation Instructions).

### 5.Return key:

- Return to the function information interface under the current running state, or return to the previous interface.

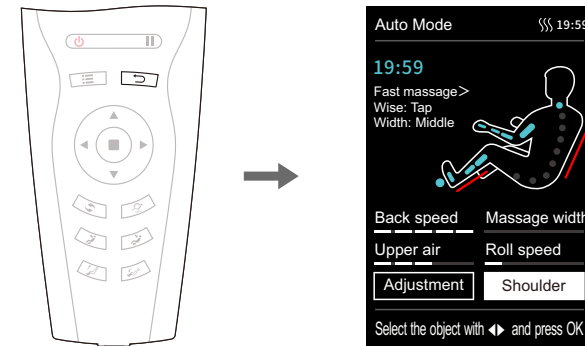

### 6.Zero-gravity key



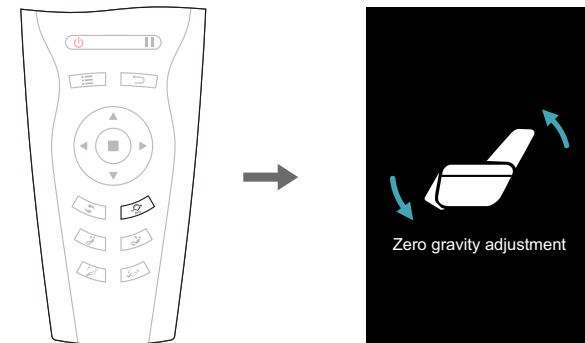

- Press "Zero-gravity Key" to adjust the position of Backrest & Legrest to zero gravity. You can choose 3 modes for zero gravity according to your own needs.



Function	Description
	Zero-gravity Key: Switch in three modes: Zero Gravity 1, Zero Gravity 2, and Zero Gravity 3 cyclically.

## Method of Usage

### 5. Lying angle adjustment key

Button	Description
	Linkage sitting key: By holding down this key, the backrest will rise slowly and the leg rest will move downward slowly; by releasing it, such UP/DOWN action of the backrest and the leg rest will be stopped.
	Linkage lying key: By holding down this key, the backrest will move downward slowly and the leg rest will rise slowly; by releasing it, such DOWN/UP action of the backrest and the Leg rest will be stopped.
	Legrest up key: Hold down the button to make the leg rest rise slowly. Release it to stop such action.
	Legrest down key: Hold down the button to make the leg rest move downward slowly. Release it to stop such action.





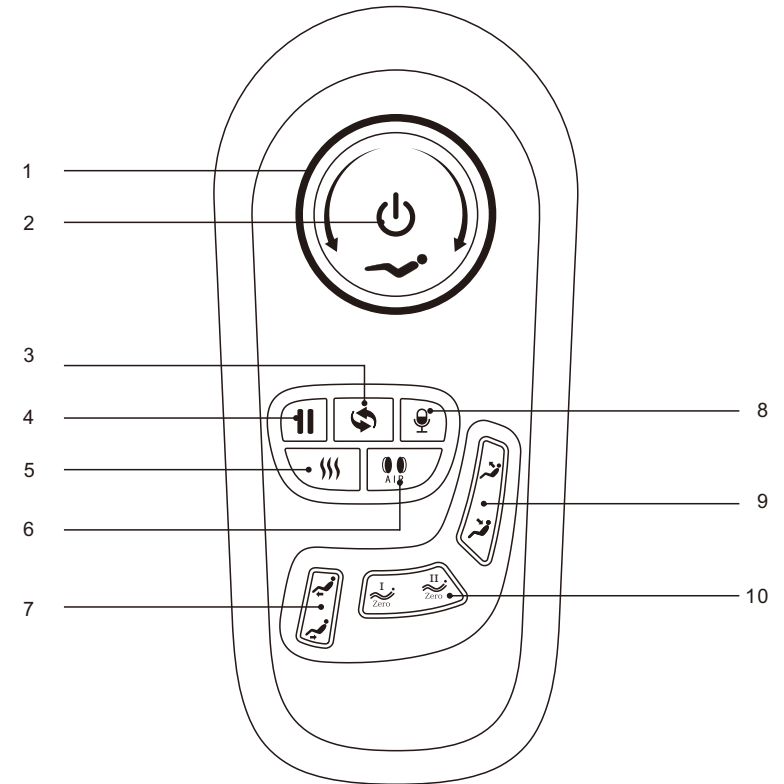









## Method of Usage

### III. Introduction to Armrest Shortcut Keys



1. Linkage adjustment key: Press it to perform linkage adjustment on the backrest for upward/downward movement.
2. ON/OFF key: Press it to start the massage chair.
3. AUTO key: Press it to enable the automatic massage function.
4. Pause/run button: Pause or run all massage functions.
5. Heat treatment key: Click the key to enable or disable the heat treatment function.
6. Air pressure key: Turn on/off air pressure massage function.
7. Legrest up/down key: Press it to make the legrest move upward/downward.
8. Voice control and wake-up button: Short press to enable the voice control function, long press 3 seconds to turn on or off the voice control function.
9. Backrest up/down key: Press it to make the backrest move upward/downward.
10. Zero-gravity key: Press it to adjust the massage chair to the angle for zero gravity.

## Method of Usage

Function	Description
	USB jack: USB charging port, you can charge smart devices (such as mobile phones). Open key: short press this key to open key.
	Power button: Short press this button to turn ON/OFF the massage.
	Linkage lying knob: By rotating this knob clockwise, the backrest will move downward slowly and the legrest will rise slowly; by releasing it, such DOWN/UP action of the backrest and the legrest will be stopped.
	Linkage sitting knob: By rotating this knob counterclockwise, the backrest will rise slowly and the legrest will move downward slowly; by releasing it, such UP/DOWN action of the backrest and the legrest will be stopped.
	Press this button during massage, and all the massage actions will be suspended at once. (i.e. the massage chair will turn off after 20min). Then press this button again to restore all the previous massage actions.
	Automatic mode key: Press it to switch among those automatic massage functions.
	Voice control and wake-up button: Short press to enable the voice control function, long press 3 seconds to turn on or off the voice control function.
	Heat treatment key: Click the key to enable or disable the heat treatment function.
	Air pressure key: Turn on/off air pressure massage function.
	Legrest up button: Pull the button to make the legrest rise slowly. Release it to stop such action.
	Legrest down button: Press the button to make the legrest move downward slowly. Release it to stop such action.
	Zero-gravity key I : the positions of the legrest and the backrest can be automatically adjusted to the positions I for zero gravity.
	Zero-gravity key II : the positions of the legrest and the backrest can be automatically adjusted to the positions II for zero gravity.
	Backrest up button: the back rest keeping lifting when pressing this button, and black rest stopped lifting once release the button.
	Backrest down button: the back rest keeping reclining when pressing this button, and black rest stopped reclining once release the button.

## Method of Usage

### IV.Voice Control Instruction

- When the massage chair is turned on or in standby mode, the sound "Hi Alice" or "Hey Alice" will be produced to enable the voice control function. Alternatively, you can press the voice control button on the armrest to enable the voice control function.
- Long press the Voice control button 3 seconds to turn on or off the voice control function.
- After such function is enabled successfully, the massage chair will reply "I am here" At this moment, once a corresponding voice control entry to be implemented is given within six seconds, the corresponding voice control function can be performed after a reply is received from the massage chair; if no correct voice control entry is given within six seconds, the voice control function automatically will be off automatically and needs to be enabled again.
- Note: When waking up the voice control function, please use English, the speech rate is moderate, Voice commands should be follow up the Voice entry.

Voice Control Entry		
Entry: "Hi Alice" or "Hey Alice". Answer: I am here.		
No.	Voice control entry	Answer entry
1	Massage on	Answer: Ok, massage on
2	Massage close	Answer: Ok, massage close
3	Comfort Massage	Answer: Ok, comfort massage
4	Relax massage	Answer: Ok, relax massage
5	Full body massage	Answer: Ok, full body massage
6	Neck and shoulder massage	Answer: Ok, neck and shoulder massage
7	Back and waist massage	Answer: Ok, back and waist massage
8	Stretch massage	Answer: Ok, stretch massage
9	Open the air pressure	Answer: Ok, open the air pressure
10	Close the air pressure	Answer: Ok, close the air pressure
11	Up the seat position	Answer: Ok, up the seat position
12	Down the seat position	Answer: Ok, down the seat position
13	Change the other mode	Answer: Ok, change the other mode
14	Go little down	Answer: Ok, go little down
15	Go little up	Answer: Ok, go little up

Note: commands 14 and 15 can only be used after command 13.



## Method of Usage

### V. Turn off power and stop massage

- During the massage process, press the power switch key to immediately turn off all massage functions, the seat back and the foot pad are reset, the massage time is up, and all massage functions are immediately turned off, and the seat back and the foot pad are not reset.
- Cut off the power supply of the whole machine, the figure (schematic diagram of the whole machine power cut).

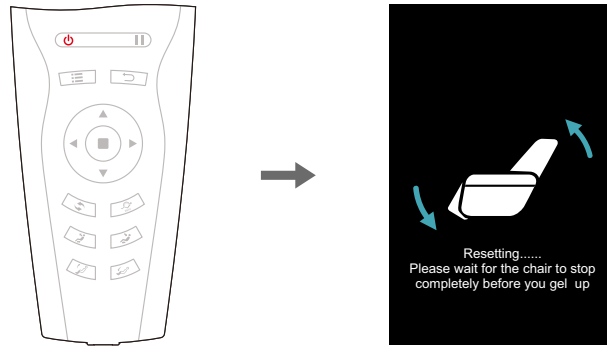

- Cut off the power supply of the whole machine, the figure (schematic diagram of the whole machine power cut).

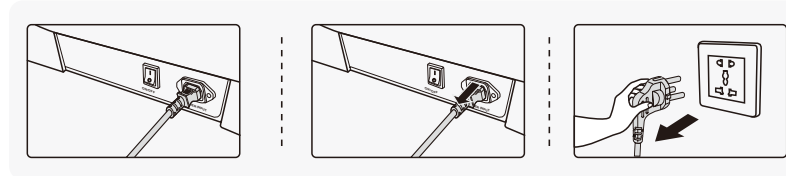

- ❶ Schematic diagram of the whole machine power turning off.
- ❷ Schematic diagram of unplugging the whole machine wiring.
- ❸ Schematic diagram of unplugging the power plug.

### VI. Operation Instructions for Bluetooth Speaker Play

1. Enter the smart device manual and open the Bluetooth function to search the new Bluetooth devices.
2. Will find the bluetooth named like (IMCM-XXXX),choose it to pair with the chair .
3. Turn on the Music Player in the smart device.

## Method of Usage

### VII. Installation Instructions for Legrest

- After connecting the wires and the air hose between the legrest and the massage chair, remove the cable ties and insert the connecting part into the seat (Figure 1).
- Place the round tubes on the left and right sides of the legrest onto the legrest support (Figure 2).

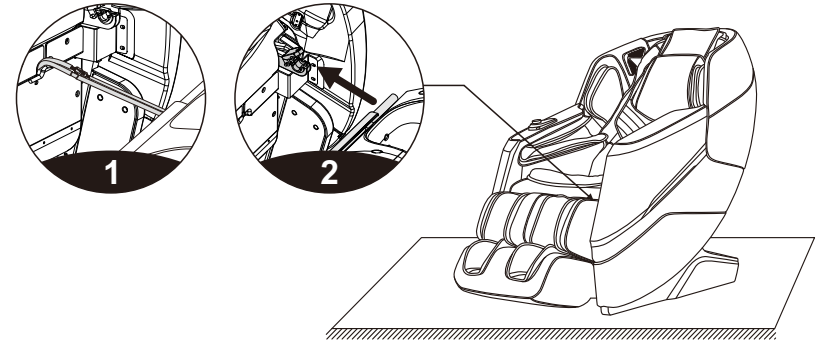

- Next, turn the legrest fixing cover over to cover the round tubes on both sides of the legrest (Figure 3).
- Fasten the legrest to the massage chair with two M4 screws (one on each side). Check whether there is any abnormality during turning up and down, or any tube, cable or wire is folded. If everything is OK, the legrest is installed (Figure 4).

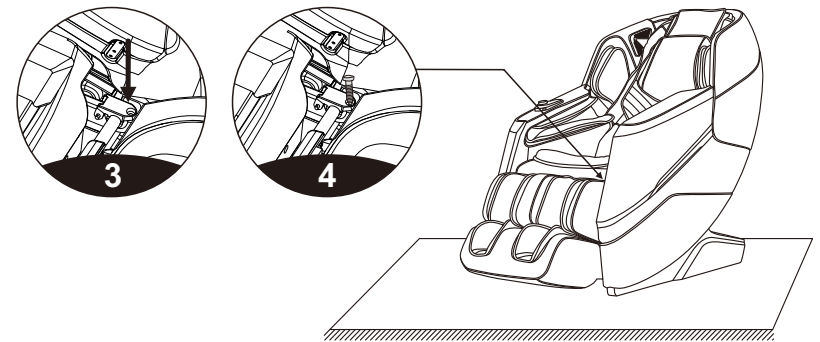

## Method of Usage

### VIII. Instructions for removal and use of head cushion and backrest

- The use of the head cushion can reduce the intensity of kneading massage on the neck and shoulders. You can decide whether to use the head cushion according to your own needs (the head cushion is recommended). The backrest and the back cushion are connected by a zipper (1). The head cushion and the backrest are connected by a zipper (2).

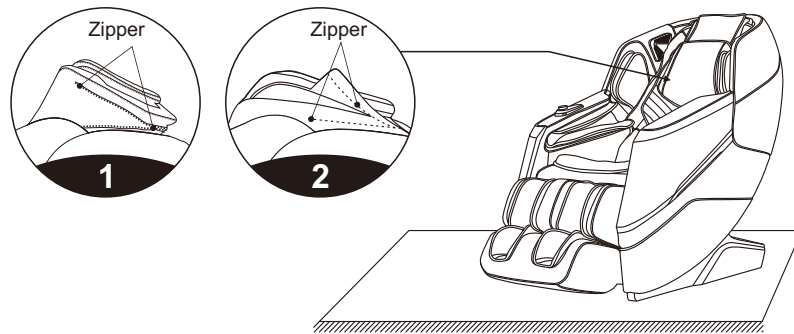

### IX. Floor Protection

- The prolonged heavy pressure on the massage chair may cause scratches on the floor. Thus, put a carpet or cushion on the floor where the massage chair is placed to avoid this damage.

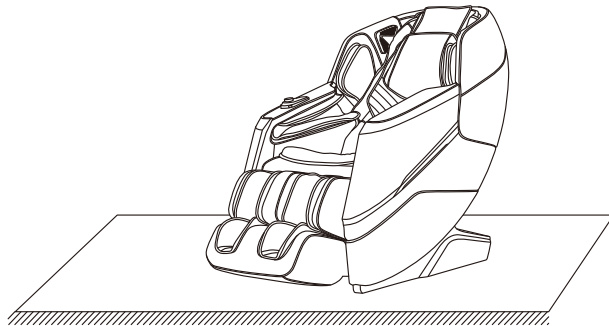

Note: Do not move the massage chair with its wheels on the rough ground or in a narrow space. At least two persons are required to lift it. During lifting, take the legrest sealing plate and backrest cover grooves as the acting points. (Do not lift the armrest directly.)

## Method of Usage

### X. Instruction for movement

- Make sure that all the wires are pulled away from the massage chair surface; then press the backrest down to a certain angle (with the center of gravity resting on the wheels), you can push the massage chair forward with hands, move it to a suitable position and gently restore it to the normal angle. (Note: During movement, you must turn off the power button first and then unplug the power cord and the remote controller connection wire.)

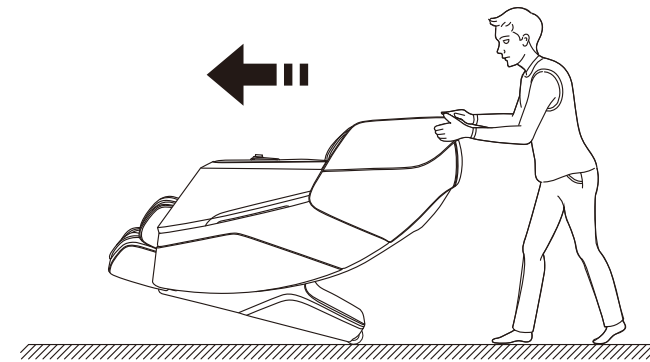

Warning : The rear moving wheels of the massage chair are only suitable for short-distance and slow movement. For long-distance transportation, please use other auxiliary moving tools to move this massage chair!

### Product Specification

Max User Height: 195 cm  
 Max User Weight: 150kg  
 Net Weight: 90 kg  
 Gross Weight: 110 kg  
 Package Measurement: 180 \* 77 \* 85 cm

Model: A335

Configure: 2

Name: Dreamliner 4D Massage Chair

Rated voltage: 220-240V~ 50Hz/60Hz

Rated power:120W

Rated time: 20min

Safety structure: Class I

Material description: PVC, PA, steel parts, electric and electron components

MATERIAL	PU	LEATHER	CLOTH	WOOD